

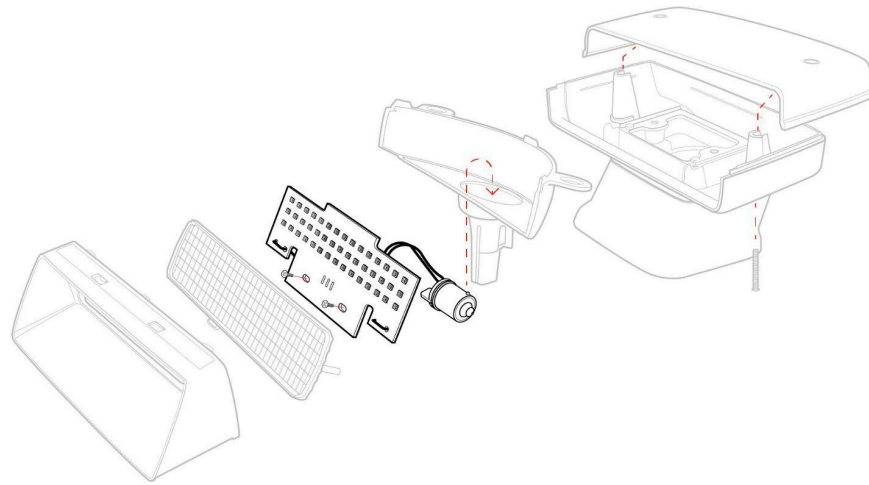

Tech Support 856-768-5700 Ext. 2 • TechSupport@LEDGlow.com

## RestoLights LED Third Brake Light for 1986-1988 G-Body



1. Using a Phillips-head screwdriver, remove the two screws holding the 3rd brake light assembly from the vehicle and unplug the connector.
2. Using a Phillips-head screwdriver, remove the two screws that hold the top of the brake light assembly in place.
3. Set the glass gasket and lens aside.
4. Remove the light bulb from the brake light housing.
5. Plug the light socket of the board into the brake light housing.
6. Using an alcohol prep pad, clean the flat area of the brake light assembly where the light board is going to attach.
7. Remove the backing from the red double-sided tape on the new light board and temporarily secure it to the brake light assembly base, ensuring the notches align with the brake light housing.
8. Using the included 1/16" drill bit, drill two pilot holes.
9. Using a Phillips-head screwdriver, install the two supplied screws to secure the light board fully.
10. Reassemble the brake light assembly and reinstall it in the vehicle.